

# Maßarbeit

With wood, hand and heart.

## Responsibility.

Portrait of the Möbel und Raum joinery.

**6 THE BEST INVESTMENT.**  
The edgeband assistant in practical tests.

**SAWS REDEFINED.**  
SAWTEQ 300 and 400 series.

**8**

**11 A STRONG COMBINATION.**  
SmartWOP and productionManager.

**LIGNA 2023**

15 –19 May, 2023

Hanover

# Thinking out loud.

LIGNA is just around the corner.

We can hardly wait: for you, it may be a while until LIGNA, but it's been keeping us busy for months. The preparations are in full swing and one thing is certain: you can expect a lot. In addition to the innovative Edge Data plug-in and the pioneering SAWTEQ 300 and 400 series, in Hanover you will experience solutions that will help you and your company to make sustainable progress.

We would like to use this issue of Maßarbeit to introduce you to some of the LIGNA topics in advance: the SAWTEQ S-200 with integrated single-axis feeder, the DRILLTEQ V-310 and the incredibly practical combination of SmartWOP and productionManager.

**Karl-Heinz Brauneisen**  
Sales manager for southern Germany

**Thomas Nesemeier**  
Sales manager for northern Germany

## CONTENTS

**LIGNA 2023** 3  
Highlights and topics

**4 SUCCESS STORIES**  
Portrait of the Möbel und Raum joinery

**REAL-LIFE EXAMPLE** 6  
The edgiband assistant

**7 CUTTING-EDGE MACHINING**  
SAWTEQ S-200 | DRILLTEQ V-310

**CUTTING-EDGE MACHINING** 8  
SAWTEQ 300 and 400 series

**9 FROM PRACTICAL EXPERIENCE** Forest edge  
**ROOT KNOWLEDGE** woodWOP 8.1

**WOOD WITH A FUTURE** 10  
Edge Data Package

**11 WOOD WITH A FUTURE**  
SmartWOP and productionManager

**WOOD WITH A FUTURE** 12  
serviceAssist

**WELCOME TO  
LIGNA 2023**  
15 – 19 May, 2023  
Hanover

## Holistic solutions from a single source.

HOMAG is not only the solution provider for furniture and component production, but also for timber house construction and solid wood. That's why this year, you will find us in three different halls with the following key topics:

**Hall 13:** Solutions for timber house construction

**Hall 14:** Solutions for woodworking shops, the furniture industry and component production

**Hall 27:** System solutions for wood processing

## Highlights and innovations.

Real innovations from different areas await you. For example, the Edge Data Package for integrated data in edge processing (page 10), the practical interaction of SmartWOP and productionManager for even more efficient CNC processes (page 11) and the saw revolution that is the SAWTEQ 300 and 400 series (page 8).

Experience the benefits live at LIGNA –  
in Hall 14, Stand H16. **Simply scan to secure  
your free ticket.**



LIGNA

# Sharing Passion.

At LIGNA: Holistic solution concepts for the future of woodworking shops.

From May 15 to 19, 2023, the HOMAG motto for LIGNA 2023 is "Sharing Passion." In other words, we share your passion for wood processing and offer you exactly the solutions you need for your requirements. The range extends from individual machines, through integrated cell concepts to complete system solutions to suit all areas of application and performance classes. In addition, innovative software solutions, services and support. In total, this makes a unique complete package of technology, competence and passion. This is typical of HOMAG, this is what "Sharing Passion" means. Our partners tapio, BENZ Tooling and SCHULER Consulting will also be present.



## Innovations, the latest technology, entertainment: Experience HOMAG first-hand.

This year, too, we offer you the opportunity to look into the engine room of our development organization: in the InnovationCenter, you will experience the future of wood processing. But it is not just future technologies that make visiting LIGNA a real experience, but also the exciting entertainment program in the event lounge. And if you have always wondered what and who it takes to set up a trade fair appearance à la LIGNA, we have something for you: on our YouTube channel, a mini-series gives you previously unseen insights into our work.



## HOMAG is bringing sustainability to the trade fair.



An important topic at LIGNA is sustainability. HOMAG has set itself ambitious targets here. One central building block is sustainable trade fair construction. To be more precise, it always has been: since 2008, we have been donating pieces of furniture made at trade fairs or the proceeds from the sale of such items to social institutions all over the world.

**HOMAG CARES** is the name of this project, which we now want to bring to life even more. In the future, we will take even greater care of our environment – with innovative machine technology, smart production processes and truly sustainable trade fair construction. Let's just say: it will pull the rug from under your feet.

## Collect knowledge. Protect forests.

Would you like to know more about batch size 1, timber house construction or future strategies for joineries? Then our newsletter is just what you need. You select your interests and receive target group-specific information that will help you and your business to move forward.

Because digital newsletters also consume energy, as part of **HOMAG CARES**, we are making forests fit for the future. In addition to our basic support, we donate €10 to sustainable reforestation projects for each new newsletter registration.

Do it like thousands of clever joiners before you: **register and do something good – for yourself and our forests.**





Möbel und Raum joinery, Schondra

# Responsibility.

Portrait of the Möbel und Raum joinery.

Maximilian Schuhmann has been a co-owner of the Möbel und Raum joinery for 15 years. There's nothing unusual about that – if it wasn't for the fact that he is 31 years old. The founder, Thomas Schuhmann, gave his son a share in the company at the tender age of 16. An unusual step, there's no doubt about that. But it shows what makes the people from Lower Franconia in Germany so special: a sense of responsibility, a willingness to take risks, vision, communication – but one after the other.

## A little dynasty of joiners: The "Hummel" joiners.

In 2023, Möbel und Raum is celebrating its 25-year anniversary, but the history of the joinery goes back a long way. Named after their original building in Schönderling, the Hummel joiners have been creating experiences made of wood for more than 150 years: first as traveling joiners, later in the fine village joinery. In 1998, Thomas Schuhmann ventured into self-employment – with plenty of ideas on board and his wife Lucie at his side. As an operations manager for store fittings, he gained a lot of experience. Above all, what can go wrong. He tried to avoid these mistakes himself, successfully. After two years, the business moved to the neighboring Schondra – to its own production hall. Since 2018, son Maximilian has not only been a co-owner, but also a managing director. His father gives him a free hand as much as possible. There has been no adverse effect on sales, which have almost doubled in recent years.



Germany – well thought out from start to finish and produced to precision. In addition to shop fitting, there is also demand for classic joinery work in Märzgrund in Schondra: kitchens, bedrooms, living rooms. The Schuhmanns are in complete agreement: this is the only way for the trainees to learn their craft. And work is only enjoyable over the long term with a little variety. It is good that Möbel und Raum is in the process of building up another pillar with timber house construction. At the moment, they are producing several residential units for which, adventurous as always, they take over almost all of the trades themselves.

And as if the work itself were not varied enough, father and son are constantly making sure that no feeling of daily grind creeps in: changing workstations, training on all machines and celebrating together. Whether this is at the Kilianifest fair with the giant ferris wheel in 2018, at the company's own event location "Jahr100Raum" or on the legendary trainee excursions – with which every year of training begins.

## Training as the foundation for success.

The trainees don't know where they are going until the annual excursion actually sets off. The excitement rises every minute until the one-week project finally starts. Then the young people arrive in the Basque Country, on a houseboat in Amsterdam or at Lake Garda. The trip unites them, creates common memories and educates them. Yes, you have read that correctly: the program primarily includes general education, social competence and company values: a high level of own initiative, entrepreneurial thinking and responsible action – with respectful cooperation. Communication plays a central role here: active language, no cursing, no nicknames, no workplace bullying. A proper image is important – in the business, at the customer's premises and in the region. Every employee is given the right clothing, from T-shirts to work trousers and jackets to a high-visibility vest. These issues seem to take root: not only are the fun factor and cohesion extremely high at Möbel und Raum, but also the speed and quality standards. It is an advantage to learn from the bottom up what

**"What have we got to be afraid of?  
We believe we can do everything."**

Thomas Schuhmann, founder and managing director

## Expertise in shop fitting – and beyond.

Thomas Schuhmann doesn't beat around the bush: "We are consumers." Whether it's textiles, shoes, gastronomy or sports – to satisfy their customers, the Lower Franconians bring in their entire experience: Who is buying? How do they buy? Where do the people come from? How do we bring them to the store? And how do we bring sales to the store? The answers aren't plucked from the air, they are based on facts throughout



Top left: Engineer Kathrin Fell doing the planning.  
Top right: Maximilian Schuhmann with Antonia Flammersberger, Inna Voichuk, Nina Weber-Romeis, Halina Havrysh, Yana Shalaiko and Ohla Shatalova (from left to right).  
Bottom left: joiner Christian Weber with trainee Vannesa Münch.  
Bottom right: the Möbel und Raum joinery at night.  
Bottom center: joiner Marius Bauer on the CNC.

matters every day. Two budding product designers, one trainee in office management, two students on dual study programs and six future joiners are currently doing this. Female employees are not uncommon at Möbel und Raum – something that is not typical of the industry: 17 of the 44 employees are women. How did the Lower Franconians manage this? With clear prospects. Maximilian Schuhmann presents the joinery profession in the schools of the region. He shows where the journey can take people – education, years spent as a journeyman, training, leadership positions. He and his father have thus inspired a number of young people for the career and business. 76 people have completed their training in Märzgrund, around 20 of whom are now part of the team. In addition, an impressive further training rate of more than 40% makes not just the company stronger. Even though some of the foremen, technicians and engineers now take up responsibility in other companies, they are still part of the joinery's strong network. This is also why the focus of training is on individual challenge and support. What are the strengths? Where are the weaknesses? Together, they can find the right application area – for which each person takes full responsibility. And, in return, they receive trust and freedom. This type of motivation is working. This is demonstrated equally by the outstanding atmosphere and the high-quality work.

**"People here don't just stand behind us. They stand by our side."**

Maximilian Schuhmann, Managing Director

#### Human success stories.

It is important to the family that everyone in the company goes their way. Fabian Eckstein, for example, completed his training together with Maximilian Schuhmann. He is now a plant manager and, according to his former apprentice colleague, works "as if it were his own shop." Thanks to people like him, the Schuhmanns can also take a three-week break to develop new ideas that will make Möbel und Raum even more successful in the future. The business continues seamlessly because everyone takes responsibility. This is what Nina Weber-Romeis does too. She originally comes from the gastronomy sector. A few months ago, she started working half-days in the warehouse. She is now taking on more and more joinery activities, thinking about processes and operating her first machines independently. Flexible working hours and colleagues from outside the field: Thomas Schuhmann is impressed by how smoothly both work – also thanks

to the continuously intuitive operation of the machine pool.

#### The whole world speaks one language: HOMAG.

"We want to work with the best machines. And this isn't possible without HOMAG," says Maximilian Schuhmann. He and his father trust the technology from Schopfloch. This is also due to the relationship with the HOMAG sales organization – in the person of Karl-Heinz Brauneisen and Daniel Medler. When Thomas Schuhmann wanted to invest in a new saw in 2017, Karl-Heinz Brauneisen brought his entire market knowledge and technical know-how into play to inspire the founder with an automated panel storage system. At first glance this was a risky step; looking back it was absolutely the correct decision. The investment has made a lot of things possible: more flexibility, higher speed, stronger growth. The machine pool is now so large that there are no bottlenecks. On the contrary, Möbel und Raum frequently produce items for fellow joiners with capacity problems – also thanks to the high level of CAD expertise in the technical center. This received

another strong boost last year. To make it as easy as possible for all employees, the engineers plan everything in advance. The rest is made possible by the HOMAG user interface. "If I can operate one HOMAG machine, I can operate all of them," says Maximilian Schuhmann from experience. In his semester abroad in Los Angeles, HOMAG machines helped with the integration – just as they do today in Märzgrund. Four Ukrainian women work in production. The simple change of language into English makes this possible. Thomas Schuhmann is supporting the women in the jungle of German bureaucracy: from checking accounts through administrative formalities to finding housing.

#### Thinking outside the box.

At Möbel und Raum they are forward-looking – including when it comes to energy. Thomas Schuhmann makes it clear: "We consume energy, so we also produce energy." The solar systems alone have been producing five times their own consumption since 2009. This allows the joinery to look to the future with confidence: Maximilian Schuhmann wants to continue to invest, create affordable housing in the region and remain flexible. Who knows which business areas are yet to open up. His father's plans, on the other hand, are clear: "Family, social projects – and vacation," he notes with a wink.

#### MÖBEL UND RAUM SCHONDRA

**Products:** Shop fittings, interior fittings, house construction

**Location:** Schondra, Germany

**Founded:** 1998

**Employees:** 47

**First HOMAG machine:** 1998

**HOMAG machine pool:**

- KAL370 AMBITION 2492 edge banding machine (today: EDGETEQ S-500) with LOOPTEQ O-300 return
- BOF 311 VENTURE 10 XL CNC processing center (today: CENTATEQ P-310)
- BHP Vantage 43M CNC processing center (today: CENTATEQ P-110)
- BHX200 CNC processing center (today: DRILLTEQ V-500)
- CENTATEQ P-210 CNC processing center
- PROFI HPP400/43/43/X panel dividing saw (today: SAWTEQ B-400)
- SBC-113/C SANDY wide-belt sanding machine (today: SANDTEQ W-300)
- STORETEQ S-200



Luisa Schäfer in action on the edge.

REAL-LIFE EXAMPLE

# The best investment in the last two years.

The edgeband assistant: Order, finally.

ZB Holzsysteme from Rastede, northern Germany, specializes in furniture and objects. The joinery works as a supplier for woodworking shops, industry, architects, planning offices or private customers. ZB Holzsysteme stands not only for first-class quality, but also for state-of-the-art technology.

**ZB Holzsysteme relies on HOMAG.**

The joinery has always owned predominantly HOMAG machines. However, it is not only the machines that enable a more efficient day-to-day work, but also the digital solutions. Managing Director Manuel zum Buttelt and his employees rely on the edgeband assistant from HOMAG, also known as the Edgeband Management Set. It provides an overview of all information about the edge material and material stock. And it thus meets the boss's wish: to be able to find the right edgeband quickly and easily.

**Never reaches its limits: The edgeband assistant.**

At ZB Holzsysteme, it is immediately clear that the assistant manages even large quantities of edgebands without any problems. More than 1000 different edgeband materials and 700 edgeband rollers with a total length of more than 32,000 running meters adorn the impressive edgeband rack. "Since the introduction of the edgeband assistant, managing these quantities is no longer a problem. We know at all times where each edgeband is and how much stock we still have," explains Manuel zum Buttelt.

All edge data is managed centrally in the materialManager app, which is part of the edgeband assistant. This means that a permanent overview of stock is available as early as the work preparation stage. The edgeband rack saves the joinery space and time. After all, fast edge changes are no longer a challenge. The materialAssist app makes it easier than ever to store edges and remove edges from storage: simply click on the tablet on the rack or read in the information via a scanner, and that's it. After edging, the edgeband roller returns to the rack, the consumption and roller dimensions are entered and the remaining length is calculated automatically by materialAssist.

**Expand digital products easily.**

The employees at ZB Holzsysteme have found their own way of determining the remaining length: "We have created specific QR codes that we scan," reports the trainee Luisa Schäfer. She is enthusiastic and believes that digitalization simplifies a lot in woodworking shops.

**"The edgeband assistant from HOMAG was the best investment I've made in the last two years."** Manuel zum Buttelt, Managing Director ZB Holzsysteme

Her training company also uses other digital products, such as productionManager, the digital job folder. Manuel zum Buttelt is also looking to a digital future: "The digital solutions from HOMAG enable a seamless work process for me and my team. Every employee has access to all information, no matter where they currently are in the company. This simply makes the work more efficient."

If you would like to read more about practical edge management, we recommend the Edge Data Package article on page 11.

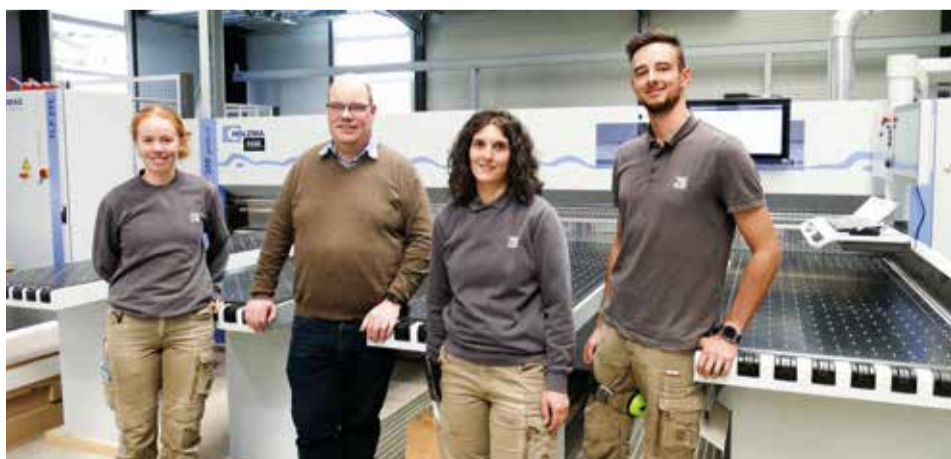

Managing Director Manuel zum Buttelt (second from left) with his edge team.

Experience the benefits live at LIGNA – in Hall 14, Stand H16. **Simply scan to secure your free ticket.**



CUTTING-EDGE MACHINING

# Accelerated feed.

SAWTEQ S-200: The new single-axis feeder STORETEQ F-100 increases productivity.

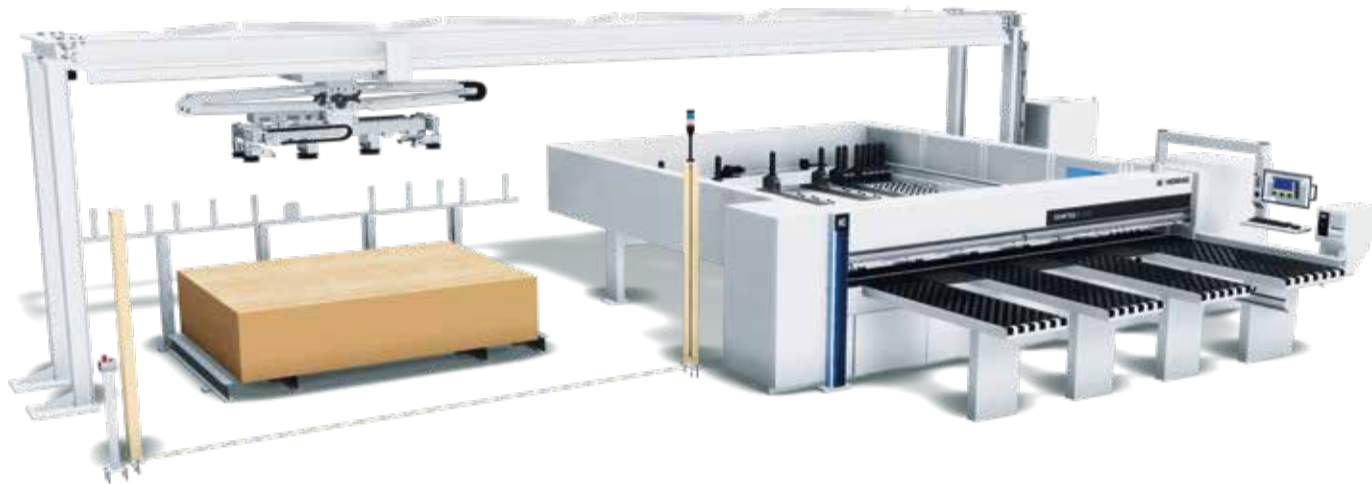

The integrated single-axis feeder STORETEQ F-100 on the SAWTEQ S-200.

Small single-axis feeders are practical, but the separate control system can keep the operator run off their feet in the cutting cell. Our newly developed single-axis feeder STORETEQ F-100 remedies this problem: you control it directly at the saw via woodStore. Operation is therefore

intuitive and easy. In conjunction with the optimized SAWTEQ S-200, this creates a complete woodworking shop cell – including convenient offcut management. At LIGNA, you can experience the accelerated feed live.

The benefits at a glance:

- **Speed up your feed:** The integrated complete solution leads to significantly higher saw performance. Additional benefit: Less time for sawing means more time for other value-adding activities.
- **Fully automatic panel handling:** A continuous process increases your productivity and saves time.
- **Optimized transport:** The single-axis feeder STORETEQ F-100 secures your panel quality.
- **Fits into any workshop:** The space-optimized feeder requires hardly any installation space.
- **More ergonomic:** The automatic feed makes work easier.
- **Standard interface:** All machines are already configured and ready for use – without any additional service support.
- **Intuitive operation:** You can operate the feeder conveniently via woodStore 8.

Experience the benefits live at LIGNA – in Hall 14, Stand H16. [Simply scan to secure your free ticket.](#)



CUTTING-EDGE MACHINING

# Reinforcements for the Raumwunder.

DRILLTEQ V-310: With robot support for woodworking shops.

A shortage of skilled workers and concerns about young talent with simultaneously increasing demands on individual products and furniture: automation and operation with minimal personnel are becoming increasingly important in woodworking shops as well. This is why our space-saving miracle, the DRILLTEQ V-310 vertical CNC processing center, can now also be supported by a robot. The reliable workpiece supply via the robot system makes the DRILLTEQ V-310 the optimal production cell in woodworking shops. The advantages of adding a new feature are obvious: no breaks, round-the-clock operation and consistently high quality. Small and medium-sized companies thus save time and also reduce the

workload of their employees. Highly qualified specialists can be used for activities that add more value for the business. In short: **Added value for the machine, the person and the business.**

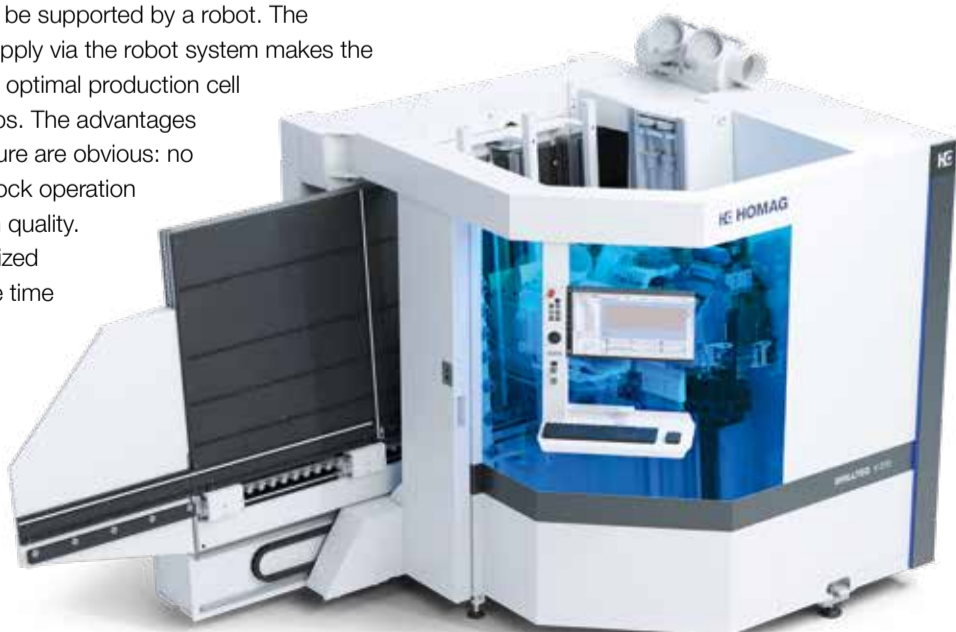

# For lovers of straight lines.

SAWTEQ 300 and 400 series:  
With revolutionary toleranceCheck.

In short, the new 300 and 400 series revolutionize all aspects of sawing. Of course, we haven't completely reinvented the saw blade itself – just almost everything else. We have consistently optimized the processes and components that are part of the sawing process, sometimes even redefined them. And because the new series offer so much added value to your business, we will present various properties to you in subsequent issues of Maßarbeit. The first step is the optional tolerance measurement, which takes the quality of your cutting to a new level.

## Integrated tolerance measurement for high-precision cutting.

With this innovative technology, you can continuously ensure the individual dimensional and angular accuracy you require – especially for stress-prone material. This creates unprecedented transparency over your panel quality. You also increase the process reliability of subsequent processing steps, such as edge or CNC processing, thanks to the integrated quality assurance. The integrated tolerance measurement thus increases quality and productivity at the same time.

## What you can look forward to in the upcoming issues.

Other highlights of the new series include the completely revised operating panel with various positioning options for better ergonomics, the machine's supporting intelligence and the easy-to-use software. But what you will be most excited about is the ratio of energy efficiency to high performance, which has no equal on the market. Experience all the benefits live at [LIGNA 2023](#).

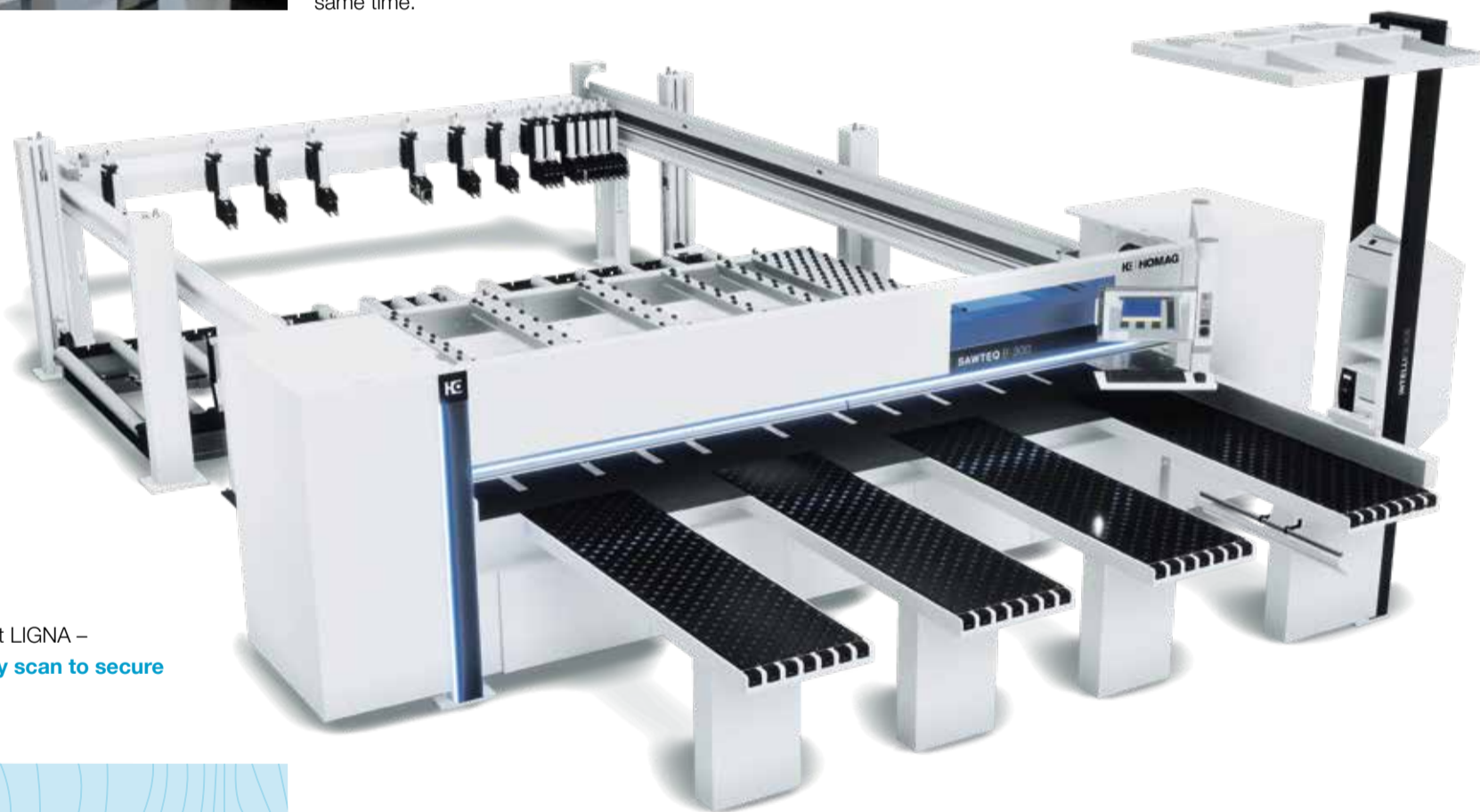

Experience the benefits live at LIGNA – in Hall 14, Stand H16. [Simply scan to secure your free ticket.](#)

### The benefits at a glance:

- **Ready for anything:** The enormous range of options available in the series also offers the optimum variant for your business.
- **Ensure your quality** and benefit from first-class cutting quality and new standards in quality assurance.
- **Unrivalled convenience in the standard version:** The new control panel and IntelliGuide guarantee the most intuitive and convenient operation on the market.
- **Performance is still an asset:** That's why we optimized all processes to meet the demands of woodworking shops and accelerated them even more.
- **Thinks and learns with you:** The saw ensures a constant level of performance thanks to intelligent technologies. This saves time and costs.
- **Well-positioned for the long term:** With this series, you are well prepared for the shortage of skilled workers and reducing the workload of your employees. At the same time, you save resources – thanks to cutting optimization and efficient suction.





REAL-LIFE EXAMPLE

# Rough edge – grown on the CNC.

powerEdge Pro Duo: Sets trends in interior design.



powerEdge Pro Duo makes it possible: single-stage forest edge with free angle.

Whether it's the dining room, bathroom or living area: customers increasingly want furniture with an original forest edge. It gives tables and console panels an individual charm that may sometimes be lost with a design that is too clear. Unfortunately, the supply of esthetically grown tree trunks is finite or you work with an edge bander. There are now two options for carpenters and joiners: put customers off or use the powerEdge Pro Duo chamfered edge in combination with the CAM plug-in professional.

At first glance, the powerEdge Pro Duo contains the same basic components as previous units: edge transport, edge snipping, glue application and post-heating. In addition, it can be swiveled from +7° to -45° via program control. But if you take a closer look, you will find the latest sensors and control algorithms. The result: experienced CNC operators get the forest edge from classic panel material.

**The benefits at a glance:**

- **Regardless of the material:** Panel material with veneer or decorative coating, veneer or plastic edges can be used.
- **Two edge shapes:** Single-stage edge with a pointed finish or two-stage edge with an additional straight part.
- **Intelligent control system:** Defined speed, temperature and contact pressure at every point on the forest edge.
- **For all components:** Edges for shaped parts, inclined edges, for a miter look or fronts without a handle and additional components with a forest edge look.

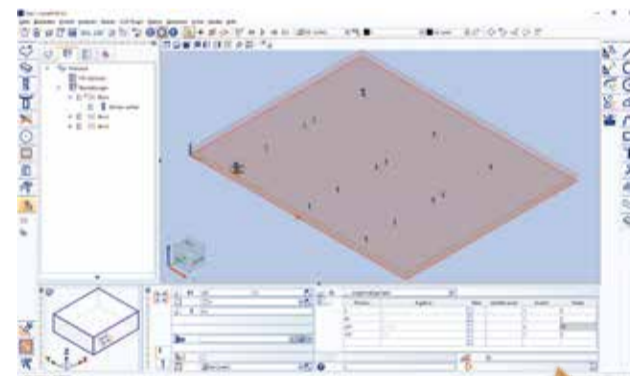
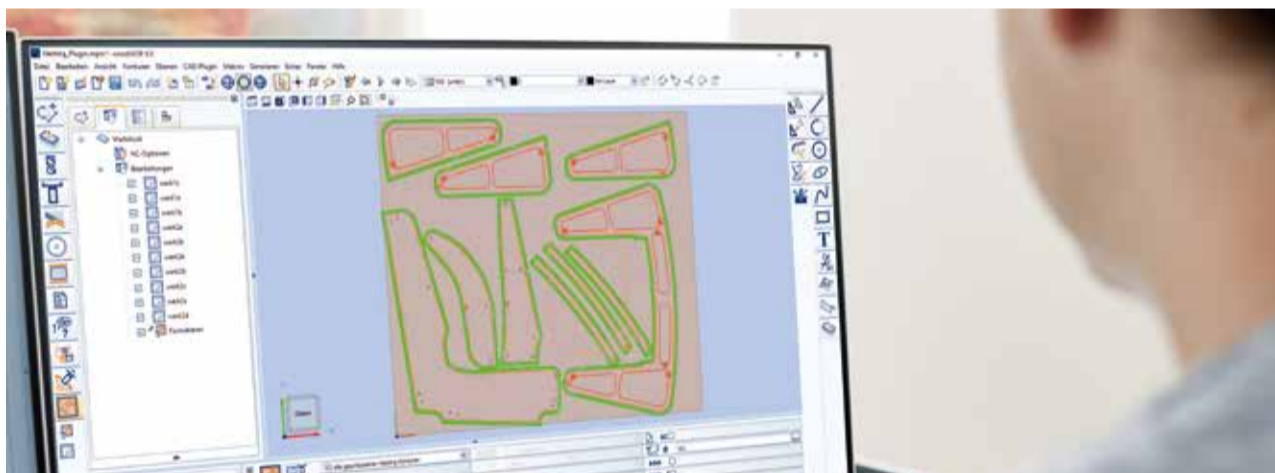

New in the block macro: duplicate processing steps in a non-symmetrical grid.

ROOT KNOWLEDGE

# Your time-saver.

woodWOP 8.1: Optimized and newly developed functions.

The latest version of our woodWOP programming software has a clear mission: to make your day-to-day work even easier in many areas. But what does that mean specifically?

woodWOP 8.1 offers you optimized and completely newly developed functions. For example, we have fundamentally revised the existing pocketing cycles. The flexibility of programming is significantly higher than before: the user can define the approach mode, reference point and form. This ultimately benefits the processing quality.

**Even more flexibility for the user.**

A new function is the automatic grouping of trimming processes that are duplicated as a component and have the same start and end point. This results in continuous trimming. The result: better quality and a faster processing time. In addition, from woodWOP 8.1, you can reproduce processing steps in a non-symmetrical grid to create more complex drilling patterns much more easily, for example.

**New for nesting.**

With the enhancements in the nesting plug-in, you can position and nest individual woodWOP programs manually on an unprocessed panel from version 8.1. The nesting plug-in then automatically generates the milling path for separating the workpieces. Another new feature is that you can generate the milling path with bars for a better hold of the workpieces.

**Real highlights in simulation and processing time calculation.**

When it comes to simulation, users can look forward to woodMotion 8, which has an impressive improved visualization. In addition, the new CNC test suite enables the processing time and operability of many woodWOP programs to be checked quickly in the work preparation. Unplanned waiting times due to faulty programs are thus a thing of the past.

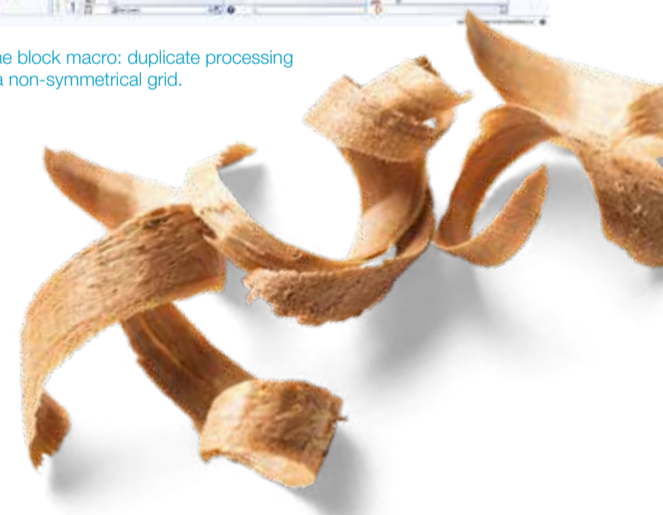

WOOD WITH A FUTURE

# Make room for the important things.

Edge Data Package: In use at the Schreinerei Lechner joinery.



Left: Martin Lechner at the EDGETEQ S-500.  
Right: The edgeband rack of the Lechner joinery.

We've all been there: one day you run out of edgeband, another day you've ordered too much. No one appears to have a correct overview. The solution: the Edge Data Package – which consists of the edge data plug-in and the edgeband assistant. This allows you to access all edgeband data from leading providers directly on the machine. The traditional Lechner joinery in Upper Bavaria, Germany, is already using the combination on its EDGETEQ S-500 – and is impressed.

Experience the benefits live at LIGNA – in Hall 14, Stand H16. **Simply scan to secure your free ticket.**



## woodCommander 5: Short digital paths.

Martin Lechner selects processing programs and edge material using the machine software. Production parameters can be recorded and workpiece-optimized machine programs created faster than ever: thanks to the 3D workpiece simulation and the check for permissible parameter combinations, the master carpenter can define the correct settings in no time at all. Once he has saved them, he can call up the default settings at any time, thereby speeding up the processing process. Other practical features in everyday work include the individually adjustable user interface, the fast orientation and the simple operation with just a few clicks. The result: all employees can use the software – and do so. "We don't have employees who perform only specific tasks. At our company, everyone does everything," says junior manager Martin Lechner. However, the major strength of woodCommander 5 lies in the internal and external data exchange: thanks to the direct connection between the machine and the edgeband assistant—which manages the edgeband material—the operator has an overview of the current stocks at all times.

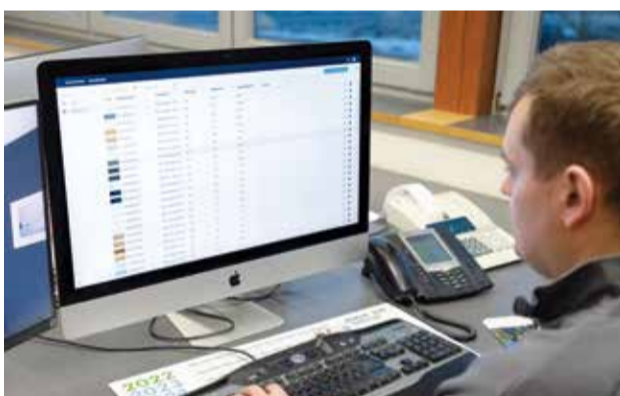

edgeband assistant. In short: three applications that complement each other perfectly and, according to Martin Lechner, significantly improve the production process.

Depending on the machine equipment, the edge data plug-in

**"We can access all material and edgeband data at any time, record data without any manual intermediate steps and, most importantly, we no longer have duplicate orders."**

Martin Lechner, Master Carpenter, Lechner joinery

## Edge Data plug-in & edgeband assistant: More efficiency at the edge.

With the two solutions, the following guiding principle applies: more is more. If you already use woodCommander 5 on your edge banding machine, the Edge Data Package is the perfect extension. This was also the case at Lechner. The practical package now exploits the full potential of edge processing. While woodCommander 5 makes direct operation on the machine easier, the plug-in links the machine to the

can be selected in the "Basic" and "Performance" variants. With "Basic," the edge lengths and all catalog data of the manufacturers can be processed, while with "Performance," the actual edge thickness of the individual rollers can also be processed. The machine then compensates for the tolerances of the edge thickness using the edge thickness compensation. Two smart digital components that make edge processing much easier.

## Edgeband assistant: Creates orientation.

- The edgeband assistant creates an **overview with all information about the edge material and material stock.**
- **This information can be called up in real time:** Is an edgeband in storage or in use? And how much of it is still in stock?

## Edge data plug-in: Connects woodCommander 5 to the edgeband assistant.

- The plug-in allows you to access a **catalog on the machine that contains all edge information** from leading edge suppliers.
- **Saves time and effort:** The plug-in transfers relevant production data such as thickness, height and available lengths of the selected edge roll directly from the app to the machine.
- The **edge banding machine reports the remaining length** of the edge roll used back to the app of the edgeband assistant via the plug-in.
- **There are two variants:** Together, we can find out whether "Basic" or "Performance" is better suited to you.

## The benefits at a glance:

- **A well-established trio:** Benefit from perfectly coordinated solutions for the machine, interface and app.
- **Complete transparency:** All information about your edgebands available at a glance.
- **Lightning-fast and error-free recording** of your edge data – without any manual intermediate steps.
- **Easy and continuous access** to all edgeband data from leading edge suppliers directly on the machine.
- **Sustainable:** The complete overview of edge stock and storage locations reduces multiple orders and costs.

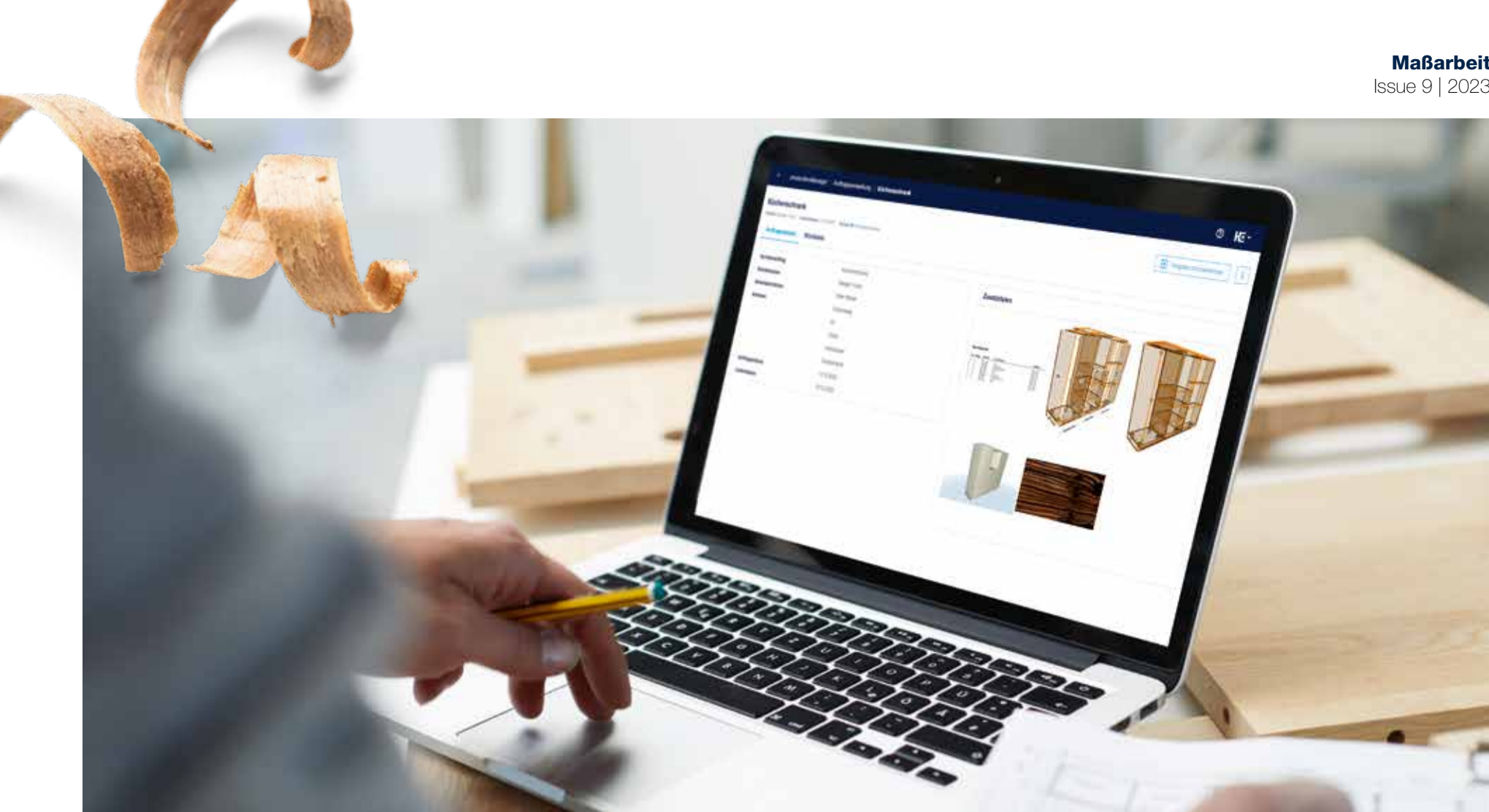

Design furniture easily and generate data.

WOOD WITH A FUTURE

# Easy design. Easy transfer.

SmartWOP and productionManager: The complete overview – for everyone, at any time, from anywhere.

Many customers want software for furniture design that is simple and flexible at the same time. In other words: SmartWOP. With the powerful CAD/CAM system, you can design individual furniture intuitively using drag-and-drop – in no time at all. Simply drag the individual components of a cabinet into a previously selected volume. In addition to the standard rectangular volume, special volumes such as a sloping ceiling or corner cabinets are also available for selection.

Experience the benefits live at LIGNA – in Hall 14, Stand H16. **Simply scan to secure your free ticket.**



**Innovative integration of woodWOP into SmartWOP.**

The integrated interaction of the software solutions allows you to select single parts of furniture in SmartWOP and to process them directly in woodWOP. The changes are transferred directly to SmartWOP and visualized there. By the way, you can save furniture that has already been designed in your own library so that you can call it up and change it at any time.

With the room planning, you can then design complete fittings from individual furniture in the shortest possible time, for example for kitchens or office rooms. Once planning is complete, all you need to do is click to generate all the production data: CNC programs, parts lists for panel cutting, fixture lists, technical drawings. The best part is that you can transfer the data directly into your digital job folder, productionManager.

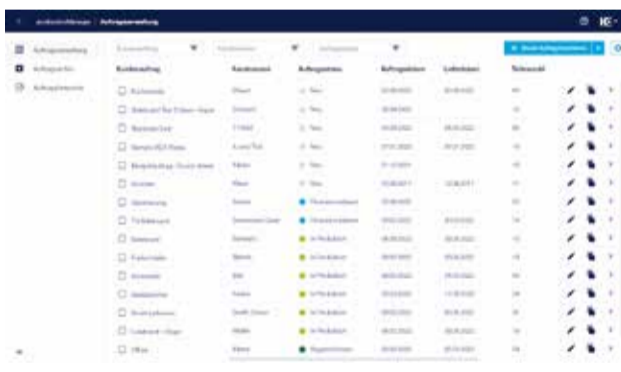

**Use data consistently.**

Many businesses still use handwritten parts lists and drawings in paper form. With productionManager, this is a thing of the past. End-to-end data from the foreman's office to the assembly area is now on the agenda. The app manages all production-relevant data for your jobs and thus significantly minimizes the use of paper documents. The job progress offers transparency so that all employees in the company can view the status of all jobs and the progress of the components and items at any time. In combination with SmartWOP, productionManager accelerates production processes many times over – without complex system changeovers, clarification of interfaces or weeks of training.

**The benefits at a glance:**

- **Simple and flexible design:** With SmartWOP, you can design furniture and furnishings in no time at all.
- **Time-saving woodWOP integration:** SmartWOP and woodWOP work together seamlessly.
- **End-to-end data for your production:** SmartWOP transfers all relevant data to productionManager with a single click or sends it to other apps and digital assistants from HOMAG, e.g. to the cutting optimization.
- **Everyone has an eye on everything:** Whether it's in the office, production or assembly – with productionManager, everyone can access all data in real time.
- **Easy to use:** Access the digital job folder from any Internet-enabled device – paper is a thing of the past.

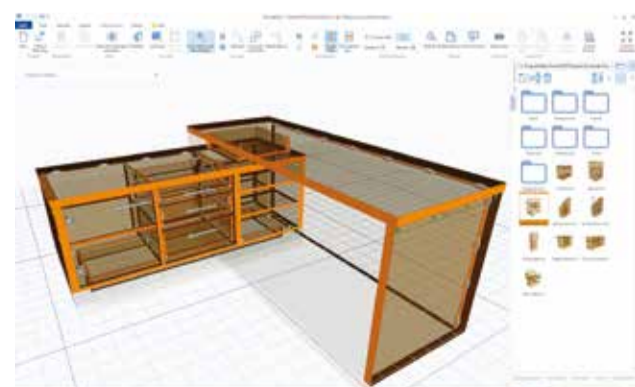

# Good service. Better production.

serviceAssist: The new maintenance dashboard and practical feedback.



Above: Jens Wickbold in front of his CENTATEQ.

Whether it's an unknown error message or unexpected standstill: there are situations in which even experienced machine operators no longer know what to do. serviceAssist offers quick help here – including without direct support from a HOMAG service employee.

## A service contract ensures the long-term availability of the machines.

serviceAssist is already in use at the Wickbold joinery in Isernhagen near Hanover. To ensure the quality of his machines, owner Jens Wickbold relies on the services provided by HOMAG. His "iPackage Classic" service contract offers him a combined service package at a fixed price: TeleService flatrate, ServiceBoard and serviceAssist. An annual inspection, including travel costs, is also included. "The fixed price in particular gives us planning security," explains Jens Wickbold.

## Two variants: Classic and Advanced.

serviceAssist is generally available in two variants. The Classic license is available free of charge for each machine that you connect to tapio. It contains the serviceRemote remote diagnostic technology and access to your maintenance and machine documentation as well as the purchase order history of your spare parts via the web app. With the Advanced variant, you will also receive step-by-step instructions for solving specific error messages. From LIGNA 2023, we will be adding the maintenance dashboard to the serviceAssist Classic functions.

## The benefits at a glance:

- **An overview everywhere:** With the new maintenance dashboard, you have an overview of your maintenance at all times – whether you are mobile or on the computer.
- **Automatically up to date:** If you wish, you can receive a monthly summary of the maintenance status of your production by email.
- **Simply produce more:** Fast troubleshooting with serviceAssist increases system availability.

**Good for you:** With the App Plus package, you get serviceAssist Advanced as one of five practical apps when purchasing a new machine for the warranty period, completely free of charge.

## "We are already using serviceAssist. An excellent tool."

Jens Wickbold, owner of the Wickbold joinery



## Maintenance dashboard: Everything at a glance.

An overview of the maintenance status of all your machines would be useful? With the new dashboard from serviceAssist, you can see upcoming maintenance across all machines and respond at an early stage. By clicking on the respective machines, you can also view and download details about the machine, the maintenance and the maintenance instructions.